

1

1

2

2

2

2

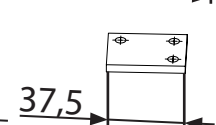
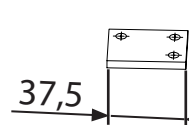
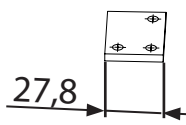
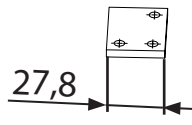
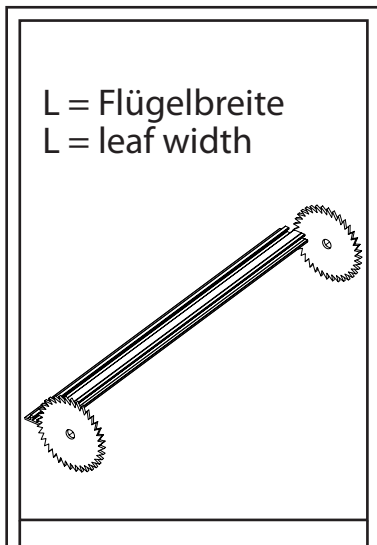
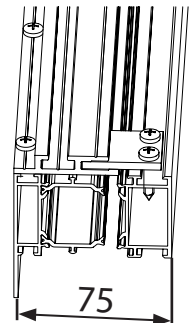
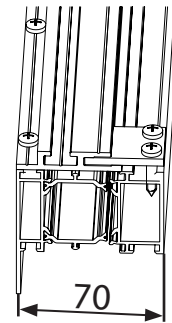
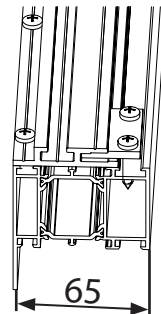
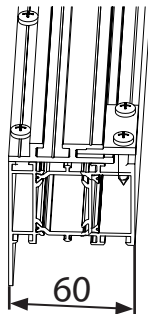
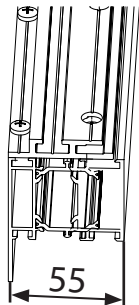
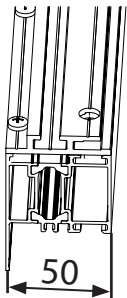

3 m

= A-7136970

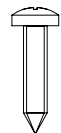

100 x
 DIN 7981 4,8x25

= A-7139080

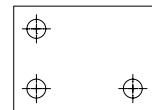

20 x

= A-8007240

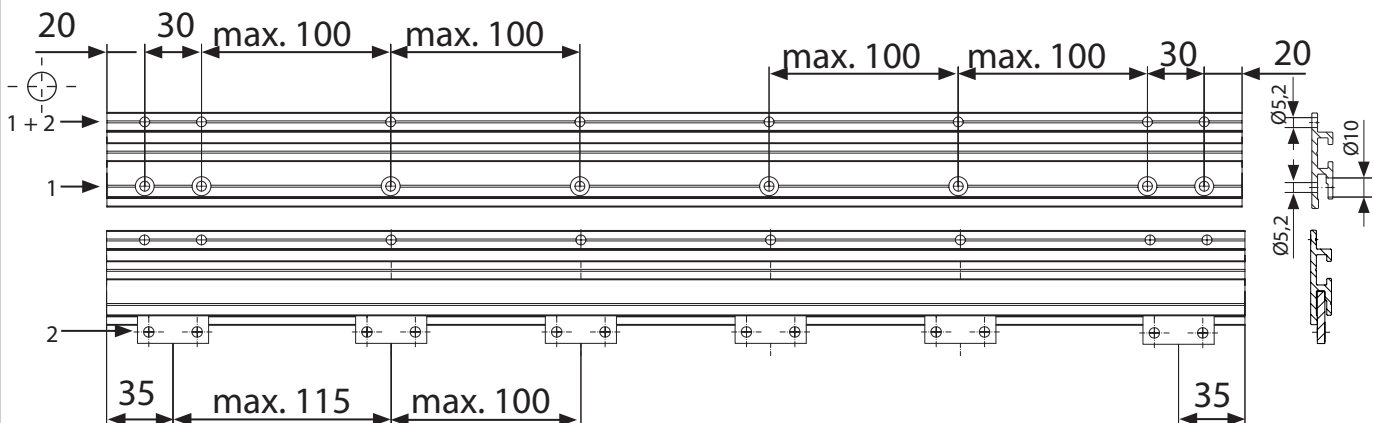

heavyMaster/Royal S65

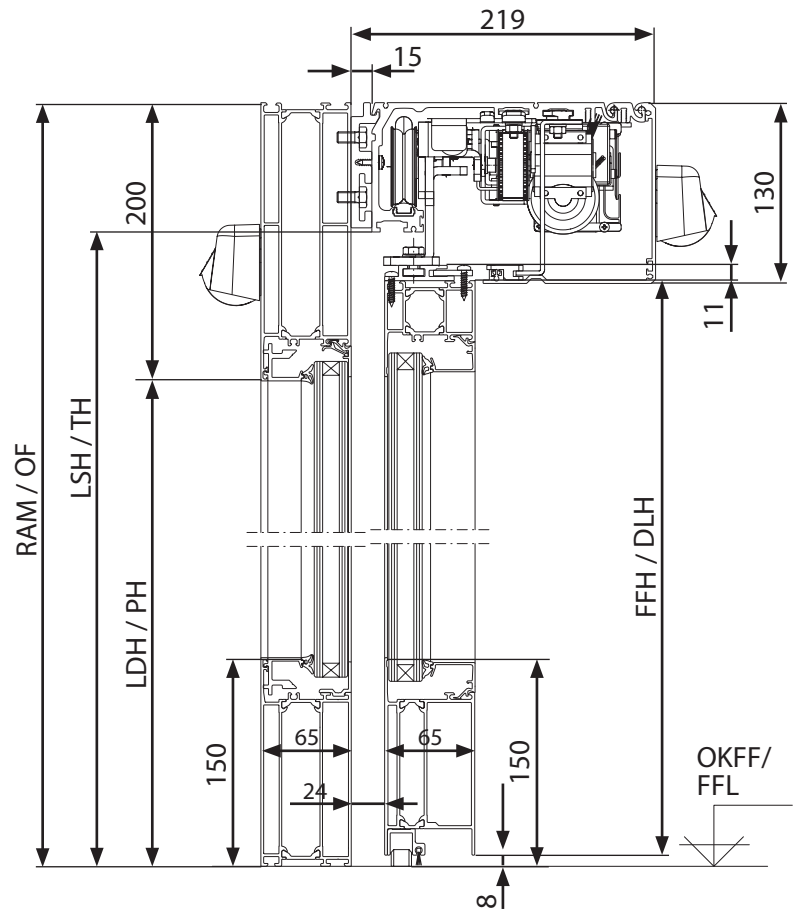

econoMaster/Royal S65

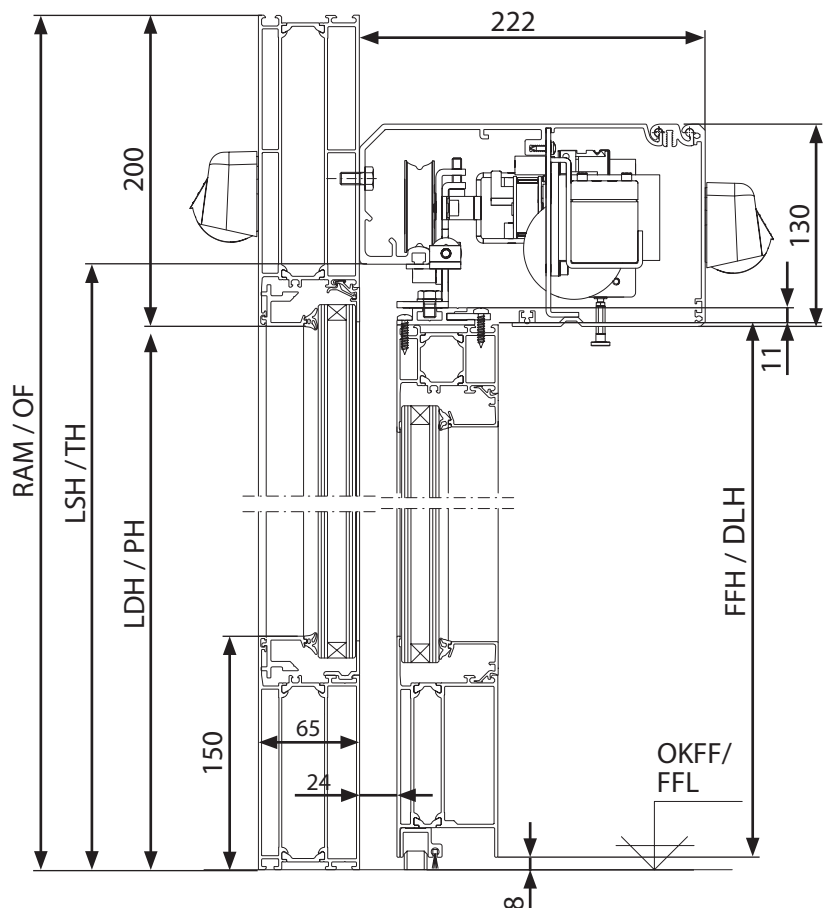

Legende:

- FFH Fahrflügelhöhe
- LDH Lichte Durchgangshöhe
- LSH Laufschienehöhe
- RAM Rahmenaußenmaß
- OKFF Oberkante Fertigfußboden

Key:

- DLH Door Leaf Height
- PH Passage Height
- TH Track Height
- OF Overall Framework Size
- FFL Finish Floor Level